

**PREVENT THE APPEARANCE OF MOVEMENT CRACKING  
IN NEW DOMESTIC CONSTRUCTIONS.**

Many new domestic constructions suffer from movement cracking. Drying shrinkage and settlement are the most common causes. These cracks rarely effect the structural stability of the extension but do look unsightly and give the home-owner cause for concern.

The Crack Control Wall Starter assists any movement to take place where the new wall joins the existing wall.

By using sleeved ties and no mortar to the vertical joint the Crack Control Wall Starter makes allowance for shrinkage movement and provides little resistance to vertical settlement.

- Suitable for up to three storeys.
- Lateral restraint from only ten ties per storey height.
- Suitable for wall up to 250mm thick.

**MATERIAL:**

Stainless Steel Profiles: 0.7mm stainless steel.

Mild Steel Profiles: 0.8mm pre-galvanised mild steel.

Stainless Steel Ties: 1.5mm stainless steel.

Mild Steel Ties: 2.0mm mild steel with Delta Coating.

Sleeves: 1.0mm PVC.

Coach Screws: M6 x 50mm stainless steel or galvanised.

Masonry Plugs: High density polythene.

**FINISH:** Stainless steel or pre-galvanised mild steel with black epoxy coated powder finish.

**INSTALLATION:**

- Offer one wall starter length to the lower wall surface. Plumb and mark out three fixing holes at the bottom, centre and top of the wall starter.
- Drill and plug wall with a 10mm masonry drill. Use the three fixing screws and retaining washers to clamp the wall starter to the wall. Repeat this process until the desired height is reached, cutting the final length of wall starter if necessary.
- Begin constructing the wall, omitting mortar from the vertical joint between the existing and new walls, making sure they abut tightly.
- Twist in the first sleeved tie 225mm from the base of the wall starter and press into the bed joint mortar.
- Continue fitting ties at maximum 225mm vertical intervals as the wall is constructed. A mastic sealant should be applied to the external vertical joint.

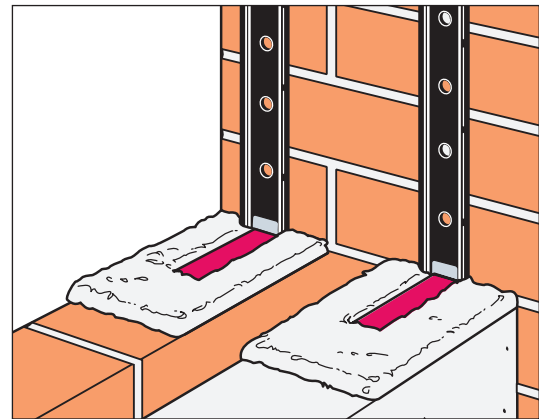

Model No.		No. of Fixings	No. of Ties	Connector Width (mm)	Length (mm)	Masonry Width (mm)
Galvanised	Stainless Steel					
CJGCCWS	CJSCCWS	12	20	85	4 x 1200	Up to 250

1. Pack comprises:
- 4 x 1.2m Length Wall Starter
  - 20 x PVC Sleeved Ties
  - 12 x 6mmx50mm Coach Screws
  - 12 x 10x50mm High Density Plastic Plugs
  - 12 x 30mm Washers

