

# MH- Mini Hanger Sacrificial Joist Installation



The MH provides a cost effective and easy to install method of fixing a set of I-joists (solid or LVL flange) that provide support for a sacrificial floor deck in buildings where work is continuing.

The MH is a one-piece galvanised joist hanger, available in a range of widths.

- Suitable for use with solid or LVL flanged I-joists.
- Seat tab ensures easy and accurate placement and alignment.
- Manufactured from 1.0mm pre-galvanised mid steel.

For the sacrificial joist installation, a MH hanger MUST be fitted to the top and bottom flanges. This prevents the rotation of the joists. The hangers are intended for one use only. Once removed they MUST NOT be re-used.

The stated performance values are based upon 2 no. MH hangers being installed as per the installation illustration below.

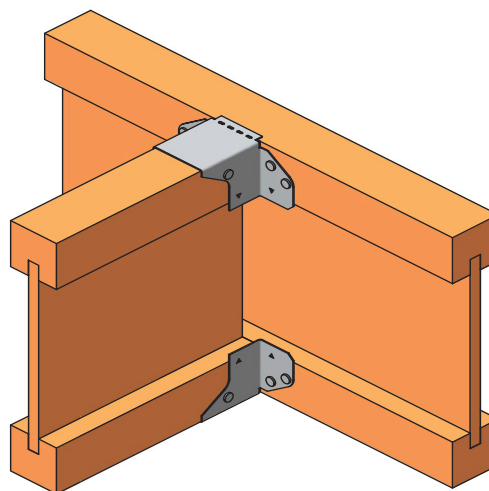
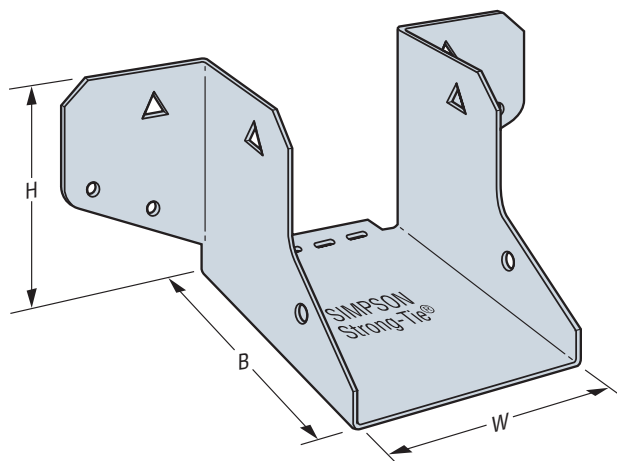

Model No.	Dimensions			Number of Fasteners (1)		Safe Working Loads (2) kN	Characteristic Loads (2) kN
	H	W	B	Support	Carried Member		
MH40	55	40	56	4	2	2.5	4.6
MH46	52	46	56	4	2		
MH50	50	50	56	4	2		

1. 3.75x30mm galvanised or sheradised square twist nails.
2. Based upon 2 no. MH hangers installed - one to top and one to bottom flange.