

LBV/BI I-Joist & Structural Composite Timber Top Flange Hanger



LBV AND BI HANGERS ARE A ONE-PIECE, NON-WELDED JOIST HANGER FOR SUPPORTING I-JOISTS AND STRUCTURAL COMPOSITE TIMBER FROM TIMBER MEMBERS.

- This design configuration has the material section where it counts, resulting in maximum load values.
- The LBV is designed especially for use with multiple ply headers of 38mm or 45mm thick.

MATERIAL:

LBV: 2.0mm pre-galvanised mild steel;
BI: 2.5mm pre-galvanised mild steel.

INSTALLATION:

- Use all specified fasteners. See "General Notes" (page 12). Verify that the header can take the required fasteners specified in the table.
- Web stiffeners are required for use with the BI hanger style and sloped or skewed LBV hangers.
- The LBV and BI hangers may be used for weld on applications. The minimum required weld for the top flanges is a 3.0 x 50mm fillet weld on each side of the top flange tabs. Weld-on applications produce maximum allowable loads listed. Uplift loads do not apply for this application. Special considerations should be taken when welding galvanised steel.

OPTIONS:

- Other widths and heights are available as a special order, contact factory for details.
- LBV and BI series hangers can be skewed and sloped to a maximum of 45°. See table for load adjustment factors.
- To order specials, put an X after the model number and add required directions and dimensions: D=seat sloped down, U=seat sloped up, R=skewed right, L=skewed left. Example: LBV359.5-2X D30 R45 is an LBV359.5-2 with a sloped down seat 30° and skewed right 45°.

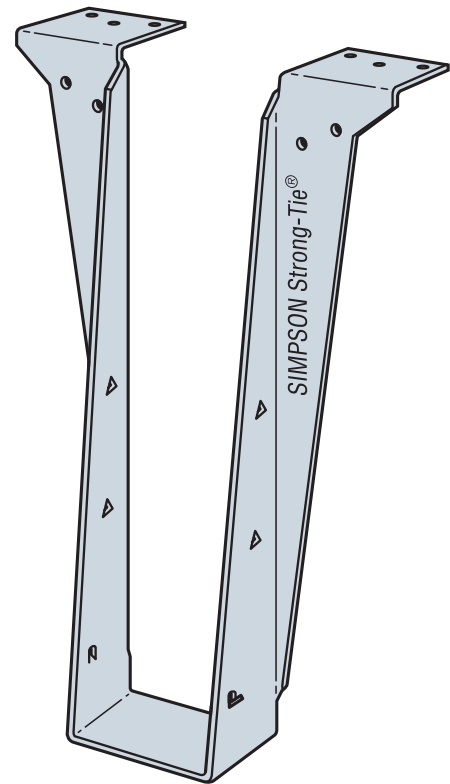

LBV

Skewed and Sloped Performance Value Adjustment Factors

Model No.	Uplift Skew > 15°	Down			Skew & Slope
		Skew Only	Slope Only ≤ 30°	Slope Only > 30°	
LBV	0.5	0.9	Table	0.8	0.7
BI	0.5	0.6	Table	0.8	0.7

Please refer to the "General Notes" (page 12) section at the front of the catalogue for an explanation of modified characteristic loadings.

LBV is acceptable for weld-on applications

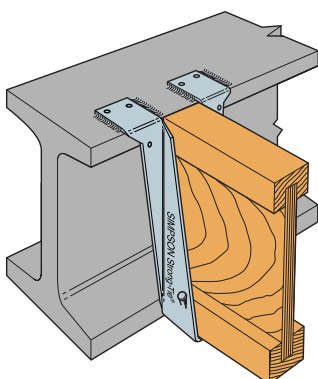

Typical LBV Installation

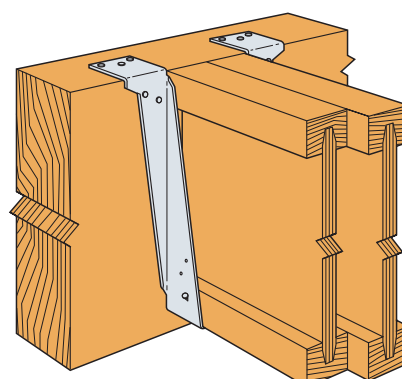



Top Flange Hangers - LBV

Joist Size		Model No.	Dimension (mm)	
Width (mm)	Height (mm)		Height (H)	Width (W)
38	140	LBV140/40	140	40
	184	LBV184/40	184	40
	195	LBV195/40	195	40
	220	LBV220/40	220	40
	235	LBV235/40	235	40
	24	LBV29.5	241	40
	302	LBV211.88	302	40
	356	LBV214	356	40
45	195	LBV195/47	195	47
	200	LBV200/47	200	47
	220	LBV220/47	220	47
	235	LBV235/47	235	46
	241	LBV9.5	241	46
	245	LBV245/47	245	47
	302	LBV11.88	302	46
	350	LBV350/47	350	47
	400	LBV400/47	400	47
	450	LBV450/47	450	47
60	200	LBV200/60	200	60
75	202	LBV202/75	202	75
	223	LBV223/75	223	75
	254	LBV254/75	254	75
	302	LBV302/75	302	75
	403	LBV403/75	403	75
2ply 38	140	LBV140/79	140	79
	184	LBV184/79	184	79
	195	LBV195/78	195	78
	220	LBV220/78	220	78
	235	LBV235/78	235	78
	240	LBV240/78	240	78
	245	LBV245/78	245	78
	300	LBV300/78	300	78
	350	LBV350/78	350	78
	356	LBV214-2	356	79
	400	LBV400/78	400	78
450	LBV450/78	450	78	
2ply 45 or 89	145	LBV145/91	145	91
	195	LBV195/91	195	91
	200	LBV200/91	200	91
	220	LBV220/91	220	91
	235	LBV235/91	235	91
	245	LBV/245/91	245	91
	302	LBV11.88-2	302	90
	350	LBV350/91	350	91
	400	LBV400/91	400	91
	450	LBV450/91	450	91
97	195	LBV195/100	195	100
	202	LBV202/100	202	100
	219	LBV219/100	219	100
	223	LBV223/100	223	100
	235	LBV235/100	235	100
	245	LBV245/100	245	100
	254	LBV254/100	254	100
	300	LBV300/100	300	100
	302	LBV302/100	302	100
	350	LBV350/100	350	100
	400	LBV400/100	400	100
	403	LBV403/100	403	100
	450	LBV450/100	450	100

Top Flange Hangers - LBV

Joist Size		Model No.	Dimension (mm)	
Width (mm)	Height (mm)		Height (H)	Width (W)
2ply 51	241	LBV4.12/9.5	241	105
	301	LBV4.12/11.88	301	105
	356	LBV4.12/14	356	105
	406	LBV4.12/16	406	105
116	195	LBV195/118	195	118
	220	LBV220/118	220	118
	235	LBV235/118	235	118
	240	LBV240/118	240	118
	300	LBV300/118	300	118
2ply 58	350	LBV350/118	350	118
	400	LBV400/118	400	118
	200	LBV200/120	200	120
	241	LBV359.5-2	241	120
2ply 60	302	LBV3511.88-2	302	121
	195	LBV195/122	195	122
2ply 60	220	LBV220/122	220	122
	235	LBV235/122	235	122
	245	LBV245/122	245	122
	300	LBV300/122	300	122
	350	LBV350/122	350	122
125	400	LBV400/122	400	122
	450	LBV450/122	450	122
	202	LBV202/125	202	125
	223	LBV223/125	223	125
	254	LBV254/125	254	125
125	302	LBV302/125	302	125
	403	LBV403/125	403	125

Top Flange Hangers - B Hangers

Joist Size		Model No.	Dimension (mm)	
Width (mm)	Height (mm)		Height (H)	Width (W)
150	202	B202/150	202	150
	223	B223/150	223	150
	254	B254/150	254	150
	302	B302/150	302	150
	403	B403/150	403	150
180	200	B200/180	200	180
	241	BI49.5-2	241	181
	302	BI411.88-2	302	180