

TFLS Timber Frame Levelling System

TFLS PROVIDES THE COMBINED FUNCTION OF LEVELLING AND FIXING THE SOLE PLATE TO THE FOUNDATION OR SUBSTRUCTURE.



THE TFLS (TIMBER FRAME LEVELLING SYSTEM) FROM SIMPSON STRONG-TIE COMPRISES A UNIVERSAL BASE PLATE AND PACKING PIECES WHICH CAN BE ADDED OR REMOVED AS REQUIRED. THE SYSTEM TRANSFERS VERTICAL AND LATERAL LOADS FROM THE TIMBER FRAME WALL TO THE FOUNDATION.

MATERIAL: Bracket - 1.0mm pre-galvanised mild steel. Packers - 2.0mm.

- Suitable for use with traditional timber frame walls and closed panel systems.
- Adaptable - accommodates structural packing up to 30mm deep.
- Universal - suitable for walls of 89mm and 140mm construction.
- Flexible - packing pieces can easily be added or removed from the base plate to achieve the required depth.
- Structural - Satisfies NHBC requirements for permanent structural packing of the sole plate when installed at load points (option 1, Appendix 6.2-B of 2008 NHBC Technical Manual).
- Multiple nail holes in bracket offer a variety of nailing options.

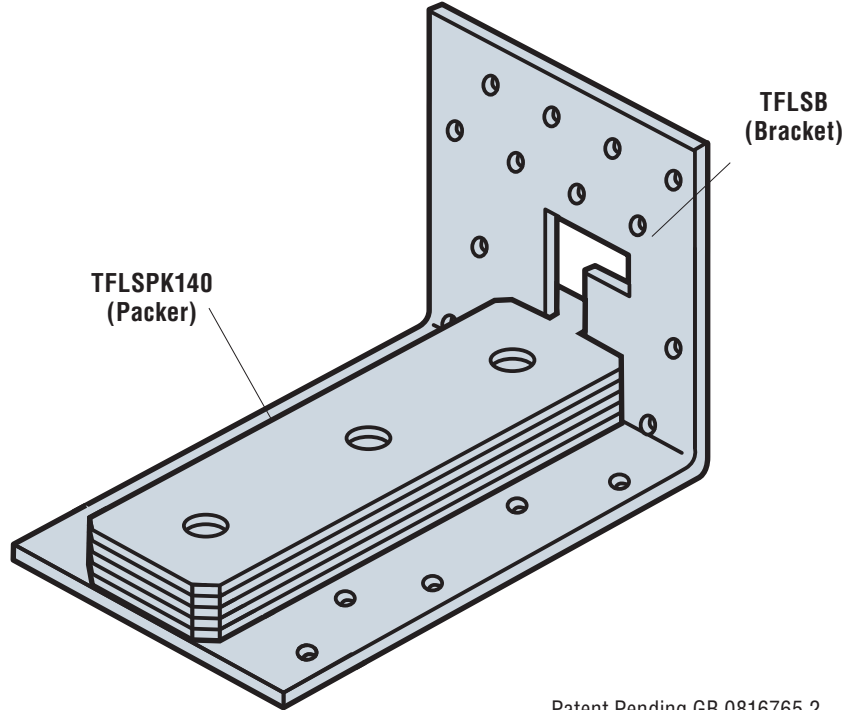

Patent Pending GB 0816765.2

TFLSB

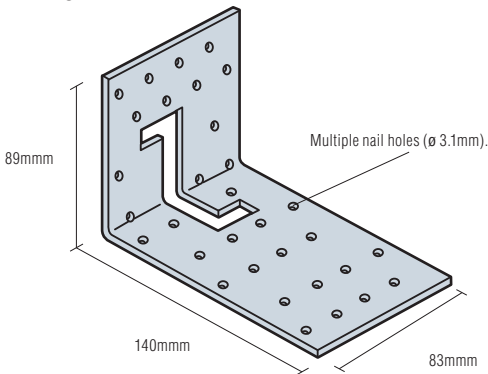

TFLSPK140
(140x39 Packer)

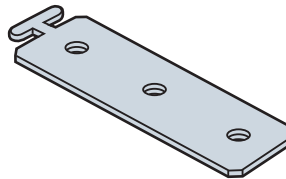

TFLSPK89
(Packer 89x39)

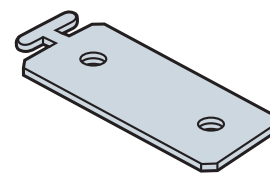

Model Number	Description	Size (mm)
TFLSB	Universal Bracket	89 x 140 x 83
TFLSPK89	89mm Packer	89 x 39
TFLSPK140	140mm Packer	140 x 39

TFLS Timber Frame Levelling System

Standard Installation

Step One

Starting at the highest point of the foundation slab, position and install the TFLS bracket, including one packer underneath the sole plate.

Step Two

Position and install a second TFLS bracket at one end of the sole plate and level to the first by adding packers to the second TFLS bracket. If necessary, install a third TFLS at the other end of the sole plate and level to the first.

Step Three

Infill between TFLS brackets with additional brackets. Level by adding packers as necessary to each bracket. Ideally position infill brackets under load points (stud positions) at centres specified by the engineer/building designer.

Step Four

Repeat process around the rest of the building. Once the ground floor walls are in situ, install packers under the load points not supported by a TFLS bracket.

TFLS Bracket and packers.

TFLS installed at 1200mm centres, unless otherwise specified.

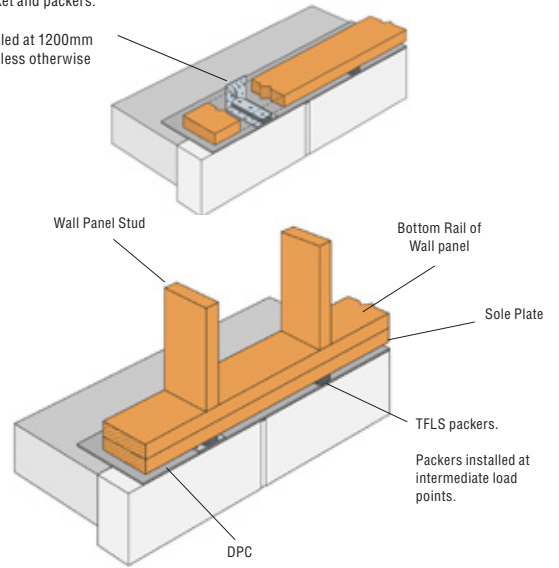

Bracket/packer configuration may be used as illustrated below.

Alternate Installation (aids levelling of the mortar bed).

Step One

Starting at the highest point of the foundation slab, position and install the TFLS bracket including one packer.

Step Two

Position and install a second TFLS bracket at the opposite end of the foundation slab and level to the first by adding packers as necessary to the second TFLS bracket.

Step Three

Infill between first and second TFLS brackets with additional brackets. Level by adding packers as necessary to each bracket.

Step Four

Using the levelled TFLS as a guide, mortar between the brackets to produce a level base for the sole plate to sit on - ensuring the mortar bed is the full width of the sole plate.

Please Note:

- The TFLS is laid on top of the DPC.
- Fixing of the TFLS bracket to the foundation and the sole plate shall be in accordance with the engineer's instructions.
- If the TFLS bracket and/or packers are installed at every load point then it is not necessary to fill the void between the underside of the sole plate and the foundation with structural grout (filling of void may be required to satisfy other regulations or requirements, i.e. Part L and Part E regulations).

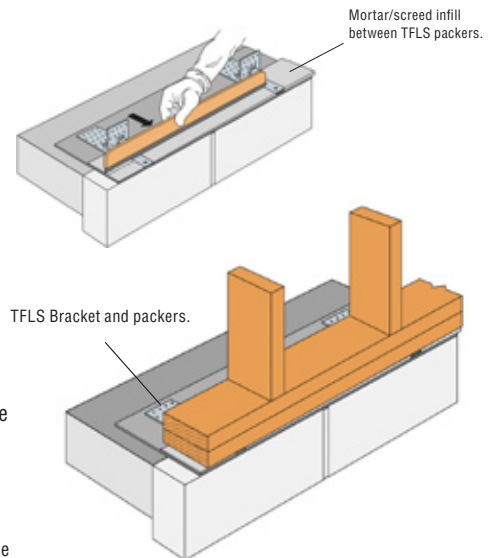

Catalogue C-UK10 © 2010 SIMPSON STRONG-TIE COMPANY, INC.

Timber Frame Connectors

SPA Sole Plate Anchor

VERSATILE ANCHOR TO ATTACH TIMBER SOLE PLATES TO CONCRETE FOUNDATIONS.

INSTALLATION:

- Fasteners can be located where suitable.
- The SPA is laid on top of the dpc, lined up and shotfired to the concrete base.
- The timber is then laid down and secured with nails through the upright flange of the anchor.

MATERIAL:

1.0mm pre-galvanised mild steel.

