



SIMPSON

Strong-Tie

Bead & Mesh

Solutions
for the
Plastering
Professional

Telephone | 01827 255600
Fax | 01827 255616
Visit | www.strongtie.co.uk

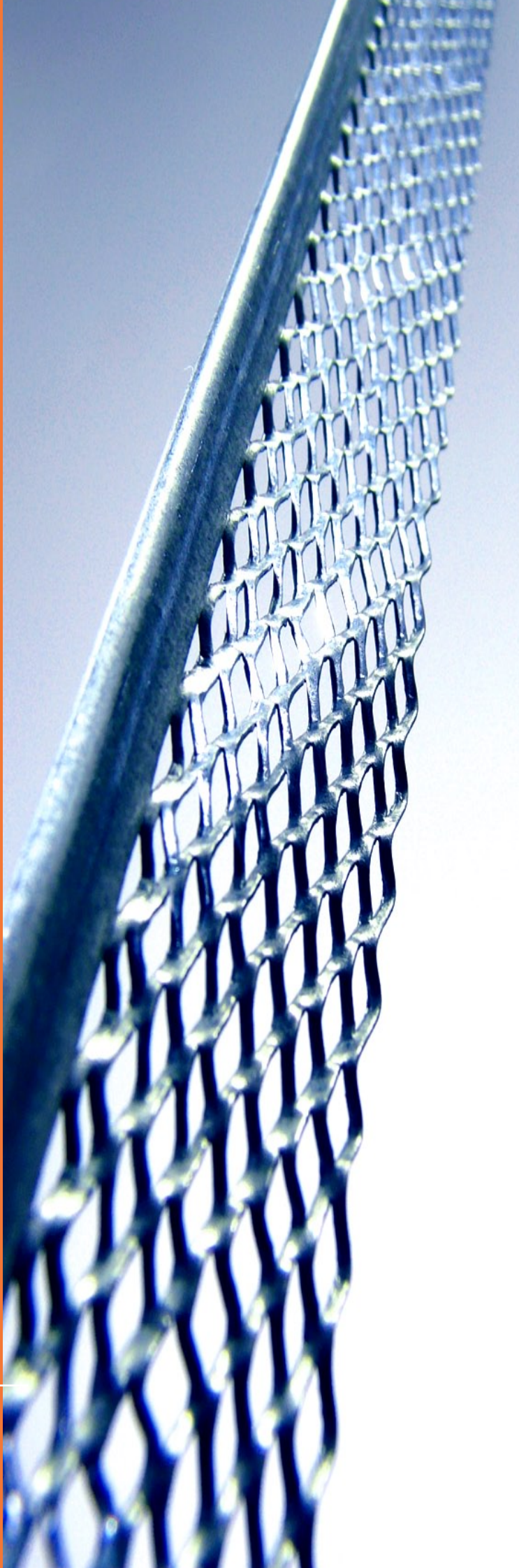

Standard Angle Bead

SAB features a 45mm mesh wing and is suitable for plaster depths of up to 13mm. A wide wing version with a 53mm flange is also available.

The SAB helps provide a true, straight arris as well as prevent chipping and cracking to vulnerable corners.

Available in 2.4m and 3.0m lengths*.

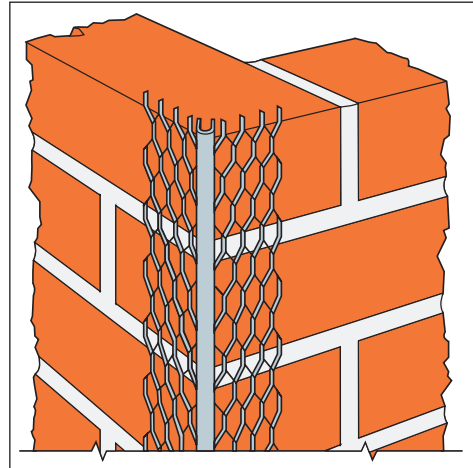

Available Finishes:

Galvanised Steel
Stainless Steel
PVC-u Plastic

Thin Coat Bead

TCB features a 25mm perforated wing and is designed for use with one coat plaster work down to just a 3mm finish.

The perforated wings provide an excellent plastering key.

Available in 2.4m and 3.0m lengths*.

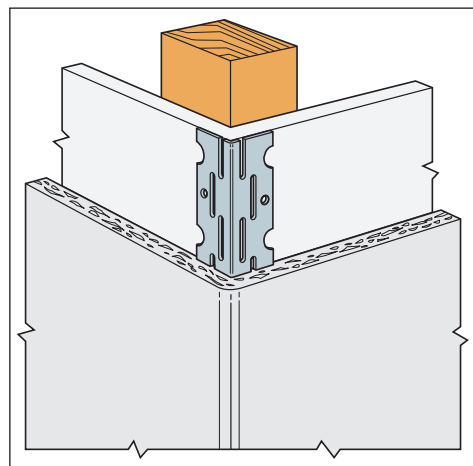

Available Finishes:

Galvanised Steel
PVC-u Plastic

Movement Bead

Movement bead (MVB) features a 65mm wing on either side to give an overall width of 140mm.

It consists of two lengths of stop bead linked by a white PVC-u extrusion to allow plus or minus 3mm differential expansion or settlement movement between adjoining surfaces.

Available in 3.0m lengths*.

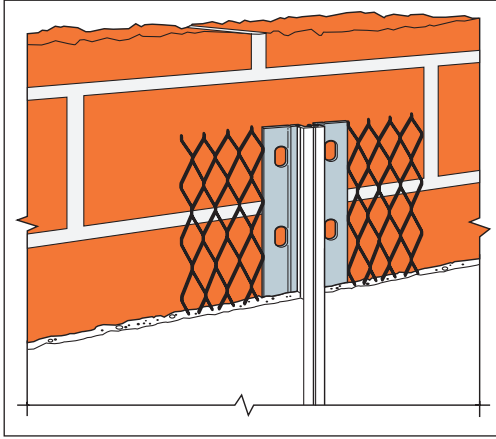

Available Finishes:

Galvanised Steel
Stainless Steel (16mm option only)
PVC-u Plastic

Mini Mesh Bead

MMB Mini Mesh can be used as an alternative to TCB Thin Coat Bead in applications where a mesh wing is preferred to a perforated one.

As with TCB, MMB can be used down to just a 3mm finish

Available in 2.4m and 3.0m lengths.

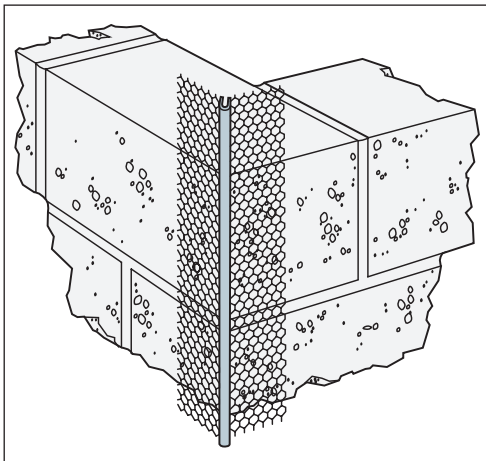

Available Finishes:

Galvanised Steel

External Render Stop

ERS is designed to provide an enhanced, aesthetic weathering detail, allowing greater reinforcement and resistance to impact damage.

External Render Stop bead features a 45mm mesh wing and is suitable for renders with a depth of 16mm to 19mm. Available in 2.4m and 3.0m lengths*.

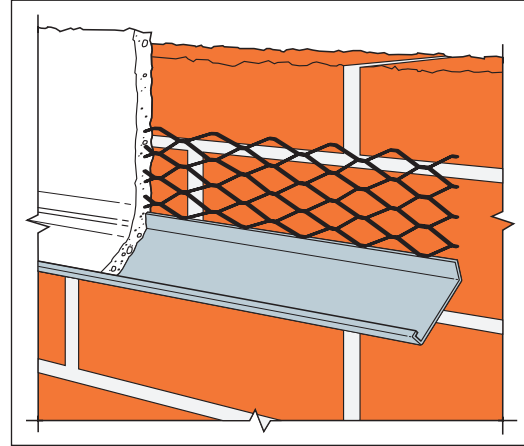

Available Finishes:

Galvanised Steel
Stainless Steel (3.0m length only)
PVC-u Plastic

Plaster Stop Bead

The PSB (plaster stop bead) range is available with a 65mm mesh wing or a 30mm perforated wing (for thin coat applications). It provides a neat finish to the plaster or render edge.

PSB can be used internally or externally.

Available in 2.4m and 3.0m lengths*.

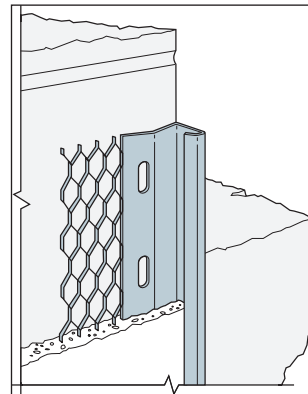

Available Finishes:

Galvanised Steel
Stainless Steel (mesh option only)
PVC-u Plastic

Plasterboard Edge

PEB features a 25mm wing and is designed to reinforce plasterboard edges.

This product is suitable for use with 9.5mm and 12.5mm plasterboard.

Available in 3.0m lengths*.

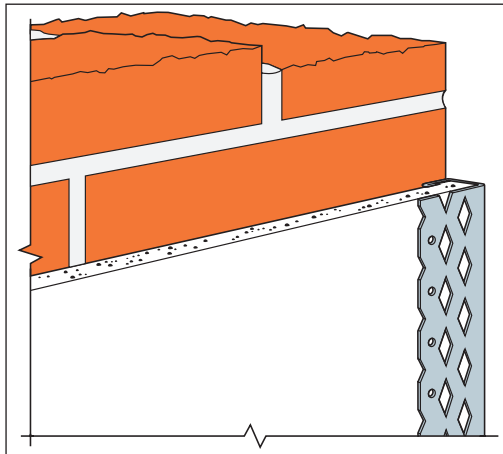

Available Finishes:

Galvanised Steel
PVC-u Plastic

Expanded Metal Lath

DML expanded metal lathing is widely used as a backing to help prevent cracks occurring where different materials meet.

Complies to SB1369: Part 1.

Available in 2.4m x 0.7m sheets, 26 gauge, 1.22kg per m².

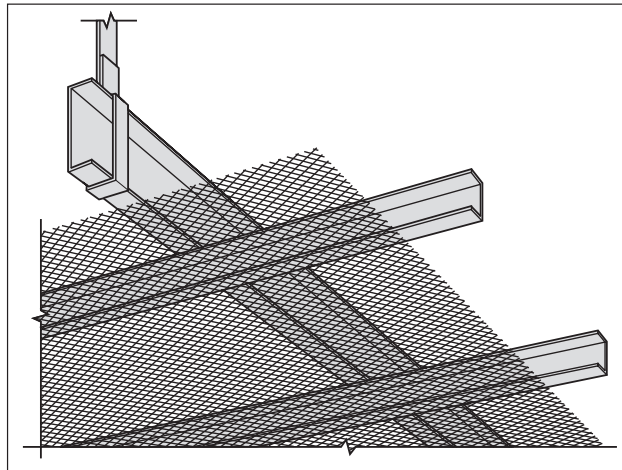

Available Finishes:

Galvanised Steel
Stainless Steel

Brick Reinforcement

Primarily used to resist local cracking under and over wall openings. CBR is supplied in coiled length of 20 metres.

CBR can easily be incorporated into mortar course and provides excellent resistance to tensile stresses where settlement occurs.

CBR is supplied in coiled lengths of 20 metres.

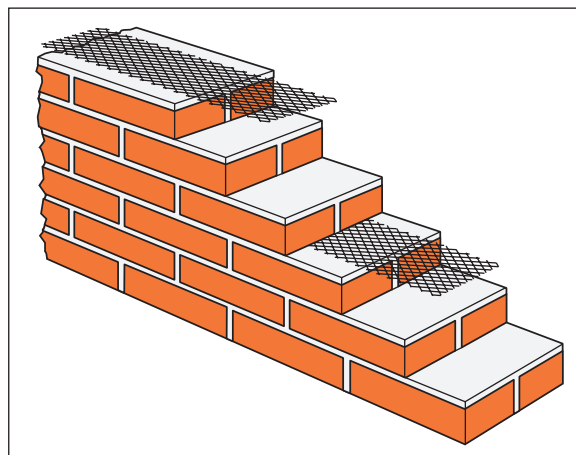

Available Finishes:

Galvanised Steel
Stainless Steel

Rib Lath

RBL rib lath provides plaster backing and is also suitable for the refurbishment of damaged or deteriorated faces of masonry walls. Rib lath can be fitted to timber or metallic supports.

Available in sheets of 2460mm x 600mm.

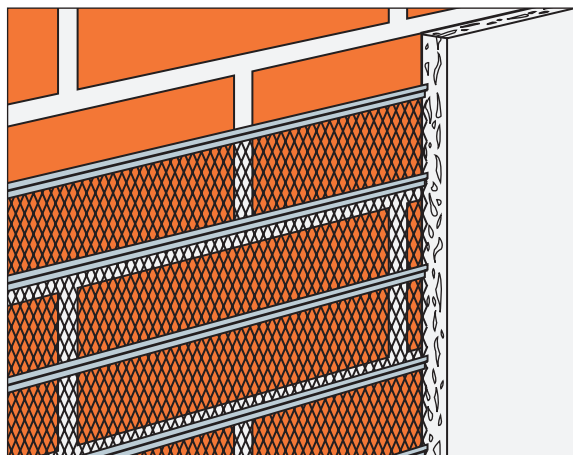

Available Finishes:

Galvanised Steel
Stainless Steel



More plastering professionals are turning to PVC-u bead...

Simpson Strong-Tie® PVCu plasterers beads are manufactured from high impact and ultra violet resistant PVC-u conforming to BS7413 for extruded profiles and in fire conditions to BS476 part 12: 1991.

The PVC-u range also carries BBA approval.

BBA Certificate: 06/4382.

* PVC-u beads are available in lengths that differ to steel manufactured alternatives, please the contact Sales Office for more information.

- superior corrosion resistance
- available in 16 colours
- easy to cut lengths on site
- easy to transport
- resistant to breakage
- uv resistant
- colour match available
- BBA approved





Manufactured in the UK, Simpson Strong-Tie® bead and mesh products are recognised by the professional plastering trade for quality and fit, either in modern building design or traditional repair.

We carry a wide range of beads, meshes, laths and arch-formers manufactured from galvanised steel, stainless steel or PVC-u, all available directly from our UK warehouse in Staffordshire.

Our commitment to service is unrivalled, we can often arrange overnight delivery, to our nationwide network of distributors or directly to site.

To find out more about how the Simpson Strong-Tie® Bead and Mesh range can help you, call us today on:

01827 255600 or
visit: www.strongtie.co.uk/fortheplasterer

The Simpson Strong-Tie® range of bead and mesh complies with the following standards:

BS 1369 Part 1: 1987

Steel lathing for internal plastering and external rendering.

BS 5262 Part 1: 1992

Code of practice for external rendering.

BS 5492 Part 1: 1990

Code of practice for internal plastering.

BS 6452 Part 1: 1984

Beads for internal plastering and drylining.

BS 8000 Part 1: 1985

Workmanship on site: Code of practice for plastering and rendering.

BS 8212 Part 1: 1995

Code of practice for dry lining and and partitioning using gypsum plaster.

EN13658 Part 1: 2005

Metal and lath beads.

For external applications we recommend the use of stainless steel or pvc-u product.

Simpson Strong-Tie®

Winchester Road

Cardinal Point

Tamworth

Staffordshire

B78 3HG

Ref. S-BM-0409