

GENUINE

Simpson Strong-Tie® Connectors



**Quality, innovation and service.
That is our Genuine commitment.**

Since we released our first joist hanger back in 1956, we have strived to build quality and innovation into everything we make and everything we do. By talking to builders and architects every day, our connectors have constantly evolved with new features to help build better, safer structures.

They'll save you time and give you peace of mind.



All products are CE marked where CPR 2013 is applicable. The C2K wall starter system is BBA approved. HES and LES straps are CE marked and LABC registered.

Pocket Guide Ref: S-PQRG17

Simpson Strong-Tie®

Winchester Road, Cardinal Point, Tamworth, Staffordshire, B78 3HG

Telephone:

01827 255600

Fax:

01827 255616

Visit:

www.strongtie.co.uk

Twitter/Facebook:

[strongtieUK](https://www.strongtie.co.uk)

SIMPSON

Strong-Tie®

Popular Hanger and Angle Bracket Sizes

Timber to Timber Hangers: JHA270/ (widths available)
38, 47, 50, 63, 75, 91 and 100mm
Timber to Timber Hangers: JHA450/ (widths available)
38, 47, 50, 63, 75, 91, 100, 125, 137 and 150mm
Timber to Timber Hangers: LUP230/ (widths available)
38, 44, 47 and 50mm
Timber to Masonry Hangers: JHM150/ (widths available)
38mm to 100mm
Timber to Masonry Hangers: JHM175/ (widths available)
38mm to 150mm
Timber to Masonry Hangers: JHM200/ (widths available)
38mm to 150mm
Timber to Masonry Hangers: JHM225/ (widths available)
38mm to 150mm
Timber to Masonry Hangers: JHM250/ (widths available)
38mm to 150mm
Additional JHM sizes available, see full technical brochure for details. HJHM hangers available for higher load applications.
Face Fix Timber to Timber Hangers: SAE380/ (widths available)
38mm to 100mm
Face Fix Timber to Timber Hangers: SAE500/ (widths available)
38mm to 150mm
Face Fix Timber to Timber Hangers: SAE620/ (widths available)
38mm to 150mm

Heavy Angle Bracket (E):
E5/2: 75 x 48 x 65mm
E2/2,5/7090: 90 x 90 x 65mm
E9S/2,5: 90 x 150 x 65
E9/2,5: 150 x 150 x 65
Light Reinforced Angle Bracket (EA):
EA444/2C50: 40 x 40 x 40mm
EA554/2C50: 50 x 50 x 40mm
EA664/2C50: 60 x 60 x 40mm
EA756/2C50: 50 x 70 x 60mm

Popular Hanger and Bracket Sizes

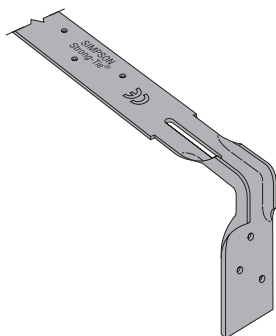

HES **Heavy Engineered Strap**

Lightweight, but heavy duty, the HES strap is engineered to provide 8kN of horizontal restraint.

A 1500mm HES can be used to span three trusses.

The HES range is CE approved.

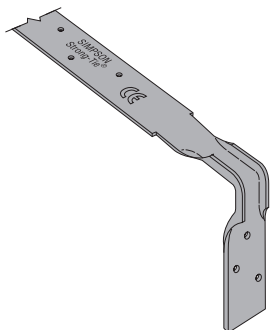

LES **Light Engineered Strap**

Lightweight, but heavy duty, the LES strap is engineered to provide 4kN of vertical restraint.

The LES range is CE approved.

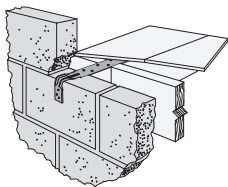

HES in floor installation.

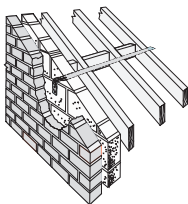

HES in roof installation.

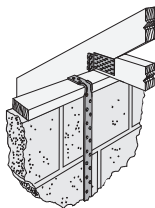

LES installation.

The HES and LES ranges are CE marked and LABC Registered solutions.

Engineered Restraint Straps

H and L Standard Restraint Strap

Conventional restraint straps. Tie wall plates to top of masonry walls and timber roof and floor systems to masonry walls.

Available in flat, bent, twisted and twisted with bend options.

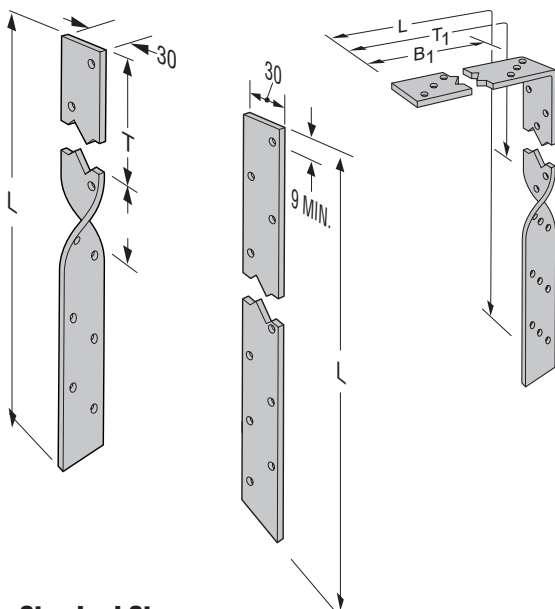

Standard Strap

TO ORDER: Specify model series, overall length, bend (B) dimension and /or twist (T) dimension.

Example: 30 x 5 strap that has an overall length of 1m, a bend at 10cm and a twist at 20cm. (See illustration for detail on measuring bend & twist dimensions).

H	10	B10	T20
Strap Type	Overall Strap Length	Bend Length	Twist Length

Standard (5mm) Strap Options

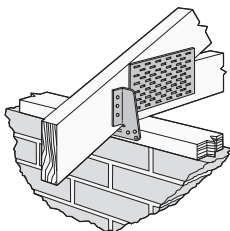

TCP Truss Clip

Attaches girder, trusses and rafters to wall plates.

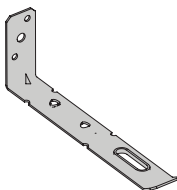

FT Galvanised Frame Tie

Ties timber and window frames to masonry

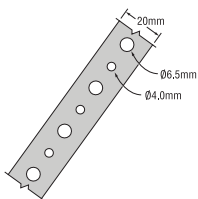

FB20A Fixing Band (10m Roll)

Supplied as a 10 metre roll, fixing band is a 20mm wide x 0.9mm thick galvanised steel strap which can be bent or twisted to suit various non-structural uses.

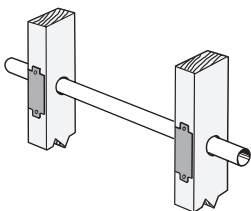

NS Nail Stopper

Prevents nails from piercing water pipes, electric cables etc. Install over utilities passing through timber studs.

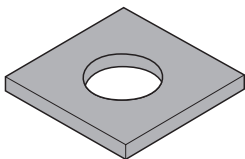

SPWG Square Plate Washer

S

Clips Ties and Other

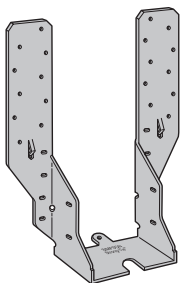

JHA Adjustable Joist Hanger

Provides excellent support, combined with ease of installation in timber-to-timber applications. Height can be adjusted at install.

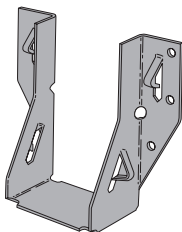
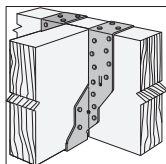

LUP Light "U" Hanger

Light duty joist hanger for supporting timber joists from timber members.

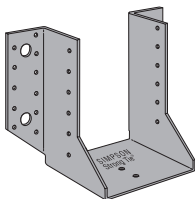

SAE Heavy "U" Hanger

Heavy face mount hanger for joists and light girders.

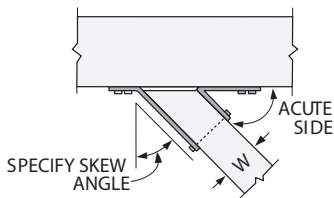

Top View: SAE Skewed Right.

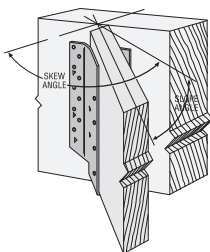

Typical SAE Sloped Down, Skewed Right.

Joist Hangers

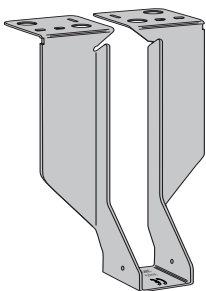

JHM

Joist to Masonry Hanger

Supports timber joists and trusses from masonry walls.

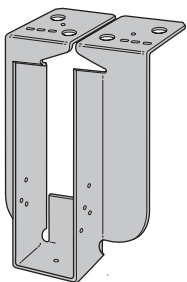
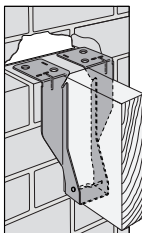

HJHM

Heavy Joist to Masonry Hanger

Heavy duty version of the JHM for applications requiring higher load bearing capacities.

JHMR and JHMS Return and Straddle Options

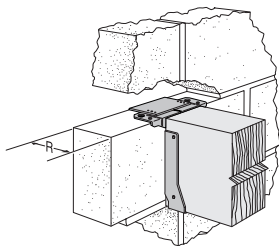

JHM with Return

A JHM with a hook over facility wrapping around three sides of the block.

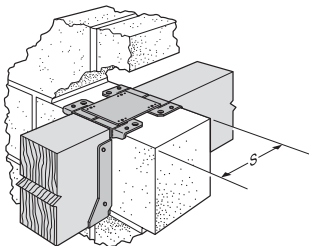

JHM with Straddle

The JHMS configuration connects hangers across support or partition walls, keeping joists aligned on both sides.

Joist Hanger Options

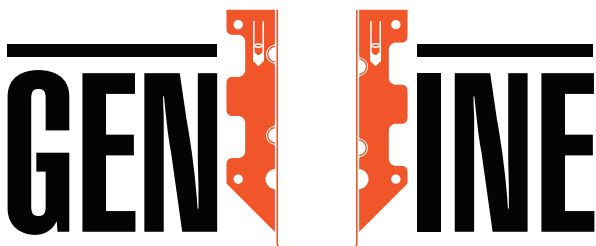

Simpson Strong-Tie® Connectors



Pocket Guide

Timber and Masonry Connectors



@strongtieUK

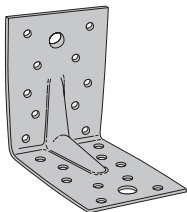

E
Heavy Angle Bracket
 Heavy general connecting at 90°.

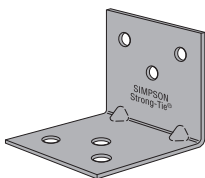

EA
Light Reinforced Angle Bracket
 For connecting and strengthening joints in general timber construction.

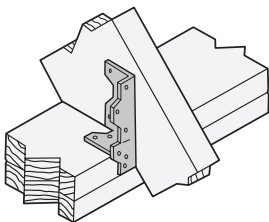

A34/A35
Universal Framing Anchor
 Exclusive bending slot allows instant, accurate bend for all configurations.

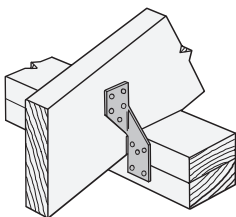

H2.5A/H4
High Wind Tie
 Attaches girders, trusses and rafters to wall plates.

Angles, Brackets and Ties

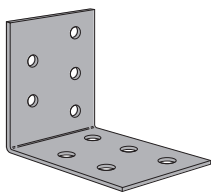

ES Nail Plate Angle Bracket

For connecting and strengthening joints in general timber construction.

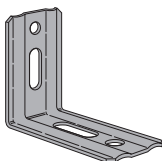

END Multi Angle Bracket

For connecting and strengthening joints in general timber construction.

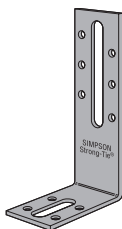

EFIX Adjustable Angle Bracket

For connecting and strengthening joints in general timber work.

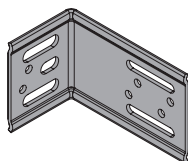

ABC Cladding Bracket

Connect vertical battens for cladding directly to the structure - no horizontal battens required.

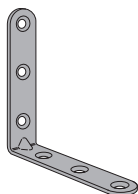

EC Light Duty Angle Bracket

For connecting and strengthening joints in general timber work.

Angles, Brackets and Ties

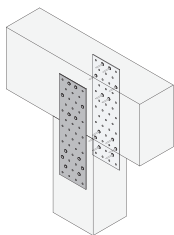

NP Nail Plate

Nail on plates for general splicing and reinforcement.

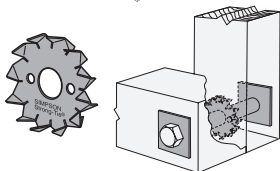

DSTC/SSTC Double/Single Sided Timber Connector

Enhances bolt performance in multiple timber beams.

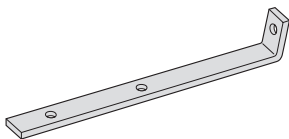

WBT Window Board Tie

Attaches window sill boards to masonry wall.

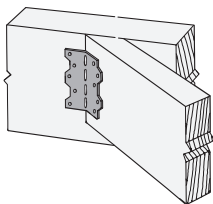

LS Skewable Angle

Attaches timber members at irregular angles - can be bent on site 0-135°.

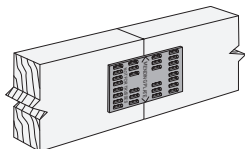

MP Mending Plate

Easy to use connector for timber splices.
No nails required.

Angles, Brackets and Ties

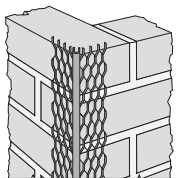

SAB* **Angle Bead**

Helps form straight arris, prevents chipping and cracking to vulnerable corners.

Available in 2.4m and 3.0m lengths.
Stainless or galvanised steel.

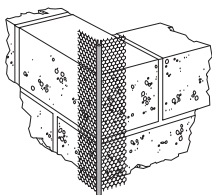

MMB* **Mini Mesh Bead**

For use with one coat plasterwork down to 3mm finish.

Available in 2.4m and 3.0m lengths.

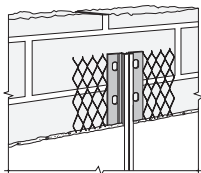

MVB* **Movement Bead**

Allows +/- 3mm expansion or contraction between adjoining surfaces.

Available in 2.4m and 3.0m lengths.
Stainless or galvanised steel.

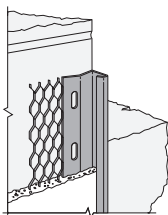

PSB **Plaster Stop Bead**

Provides neat plaster/render edge at openings, the abutment of walls and for ceilings.

Available in 2.4m and 3.0m lengths.
Stainless or galvanised steel.



TTCB **Hook On Thin Coat Bead**

TTCB (toothed thin coat bead) features tiny teeth at 40mm intervals which grip the plasterboard - simply position the TTCB and tap it into place by hand. No nails required!

*** We only recommend the use of stainless steel**

Bead and Mesh (available in galv

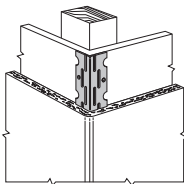

TCB Thin Coat Bead

For use with one coat plaster applications onto plasterboard.

Available in 2.4m and 3.0m lengths.

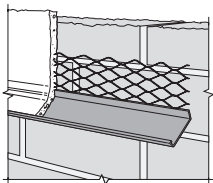

ERS* Render Stop Bead

Provides reinforcement to aesthetic weathering detail.

Available in 2.4m and 3.0m lengths.
Stainless or galvanised steel.

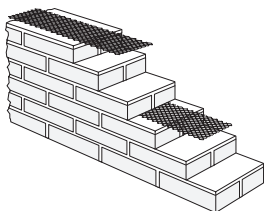

CBR Brick Reinforcement

Provides added strength and stability for masonry applications. Supplied in coils.

Available in 20m lengths.
Stainless or galvanised steel.

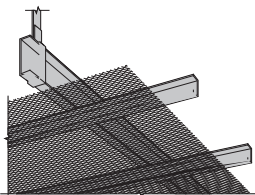

DML/RBL Expanded Metal Lathing

Provides added strength and stability for masonry applications. Supplied in sheets.
Stainless or galvanised steel.

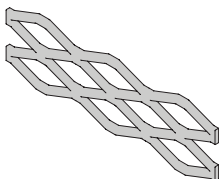

SML/SMH Security Mesh

Available in normal and heavy duty variants, security mesh sheeting can be layered with wall, partition and ceiling panels or brickwork to provide added security.
SML (1250x2440x1.14mm).
SMH (2440x1220x2.69mm).

ess steel products in external applications.

galvanised steel, stainless steel)

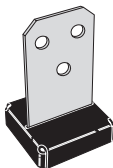

CPT **Concealed Post Base**

The CPT provides a discrete connection between post and surface. Features a 22mm standoff to prevent post end decay. Dowels are included.

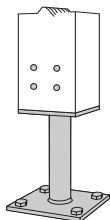

PBH **Heavy Duty Post Base**

Heavy duty, elevated post base available with 75x75mm or 120x120mm top plates. Dowels included.

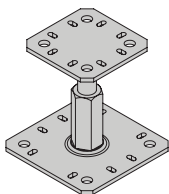

PPRC **Adjustable Post Base**

Allows off the ground adjustment from 100 to 150mm, even after the post has been installed.

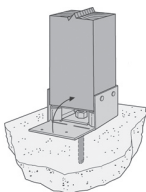

ABW **Economy Anchor** **Base For Posts**

Provides 25mm stand off from concrete. May be installed in new or existing surface.

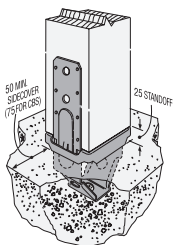

PBS **Post Base With Standoff**

Provides 25mm stand off from concrete. Set the PBS when pouring the concrete.

Post Bases

WTS4

Type 4 Wire Tie

Type 4 stainless steel, for use in party wall applications. Double drip format. Available in 200, 225, 250 and 275mm variants suitable for 50-150mm cavities in 10m/2 storey applications.

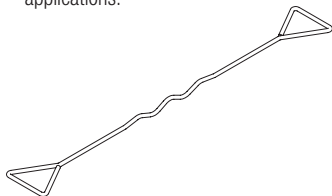

WTS2

Type 2 Wire Tie

Type 2 stainless steel, medium duty cavity wall tie. Available in 200, 225, 250 and 275mm variants suitable for 50-150mm cavities in 15m/3 storey applications. **WTS3** Type 3 wire tie also available in 300mm lengths.



IRC001

Insulation Retaining Clip

Suitable for use with all Simpson Strong-Tie cavity wall ties.

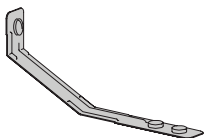

BTS

Brick to Timber Stainless Steel Wall Tie

Designed to tie brickwork leaf to timber frame and allow for timber shrinkage. Suitable for 50-100mm cavities.

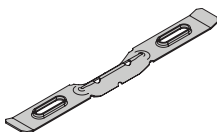

CWT

Cavity Wall Tie Stainless Steel

Cavity strip tie suitable for 50-175mm cavities.

Features a deep 'V' profile to prevent mortar build up and prevent moisture crossing the cavity.

Masonry Ties

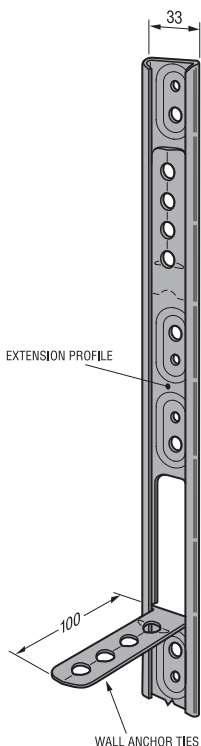

C2K

Crocodile 2000 Wall Starter

Universal connector for walls 60mm to 250mm wide with fully adjustable anchor ties.

Approved for up to 8 metre, 3 storey work. Ideal lateral support to masonry walls in conversion, extension and new building work.

Pack includes fixings.

Available in stainless steel (C2KS) and powder coated galvanised steel (C2KG) options.

C2K is unique in that it features ties built into the profile that can be snapped out when ready to install (so they don't go missing on site) as well as a universal channel which allows the ties to be positioned anywhere along the profile making them easy to match up to the block work or brickwork.

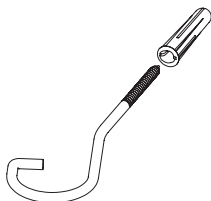

WST

Wall Starter Tie

Screw in wall starter with nylon wall plug provides lateral stability to brickwork or blockwork walls. Suitable for internal and external use. Available in 135mm lengths.

Can be installed horizontally or at a 30° angle to the mortar joint.

Wall Starters